

HÉRCULES GLT LINE

More versatility and quality.
Ideal for **reverse logistics**.



The first line of boxes in Brazil that follows the VDA-GLT standard and can be moved using a pallet truck or forklift, and can be stored directly on the shelves. Its innovative design combines simplicity and robustness, in addition to its high quality raw materials that guarantee high resistance. To further optimize your Hércules box, also use the extender.



GREATER IMPACT RESISTANCE

Interlocking between the foot and the base offers high resistance to impact from forklift forks.

LOW MAINTENANCE COST

Components can be replaced individually.

EXTENDER (Optional)

METAL PROTECTION (Optional)

GREATER ROBUSTNESS AND SAFETY

Rods made of high-resistance plastic material, free from oxidation and reducing the risk of accidents.

100% SAVINGS ON AUXILIARY MATERIALS

No need for Stretch.

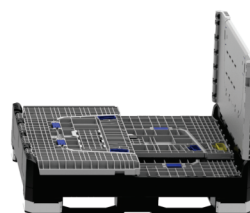
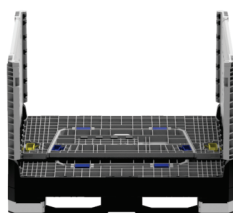
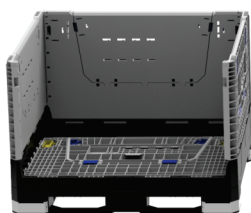
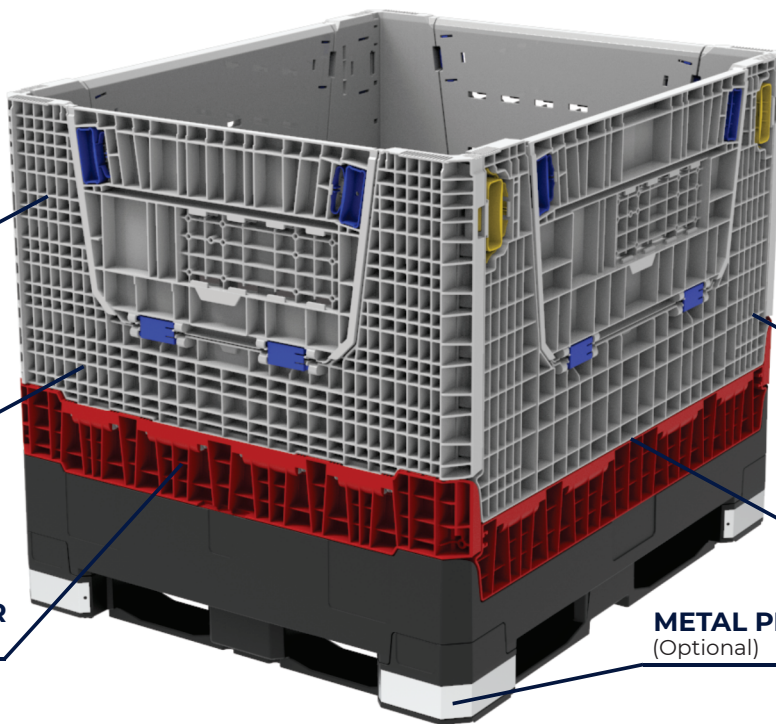

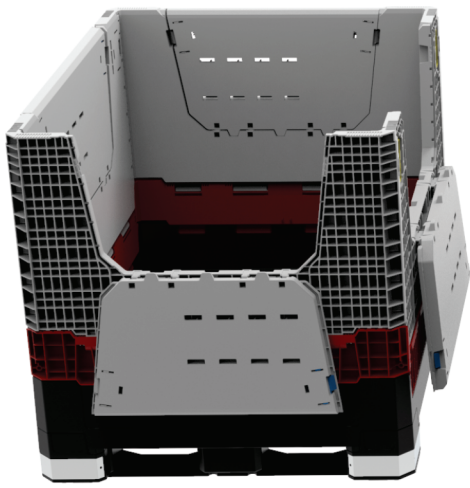

GLT 121010



GLT 121086

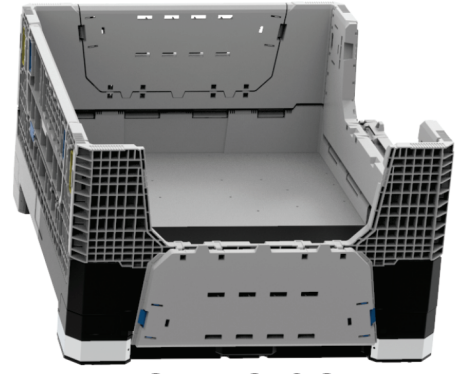

GLT 121065

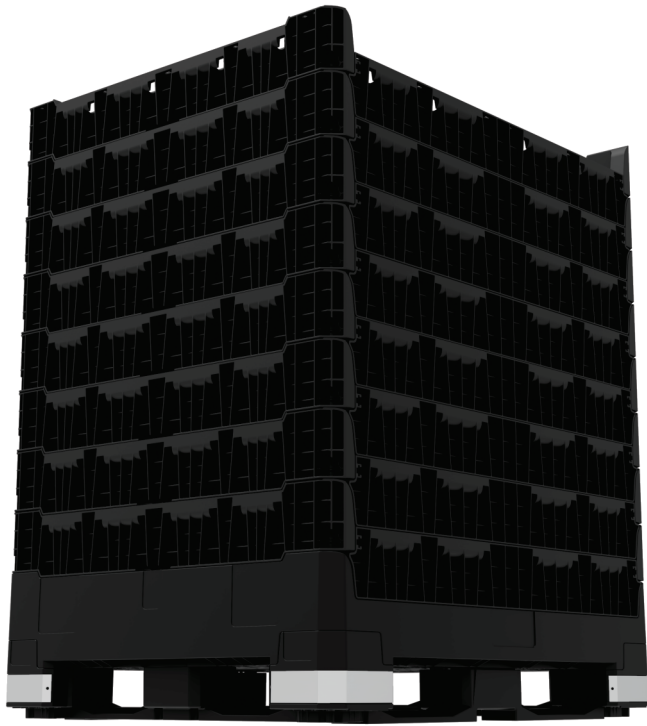

COVER (Optional)

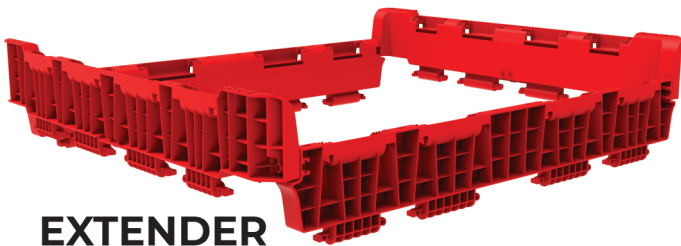

EXTENDER
(Optional)



CONDUCTIVE 
Ideal for transporting
electronic products.



Resistant to impact, oil and temperature variations.
No metal parts in the composition.

GLT LINE	NOMINAL DIMENSIONS length x width x height (in)	EXTERNAL DIMENSIONS length x width x height (in)	INTERNAL DIMENSIONS TOP length x width (in)	INTERNAL DIMENSIONS BASE length x width (in)	USEFUL INTERNAL HEIGHT DIMENSIONS (in)	WEIGHT (lbs)	CAPACITY (ft ³)	MATERIAL
121065	47,24x39,37x25,59	47,24x39,37x25,59	44,09x36,22	44,09x36,22	18,27	110	16,88	PP
121086	47,24x39,37x33,86	47,24x39,37x33,86	44,09x36,22	44,09x36,22	26,54	132	24,51	PP
121010	47,24x39,37x39,37	47,24x39,37x39,37	44,09x36,22	44,09x36,22	32,05	154	29,66	PP

*Check for other sizes